



To the product video

## BRIEF INFORMATION

### Module 90 S-series

- › Halogen replacement series (1,850 lm) and premium LED work lamp series (4,000 lm)
- › Longer service life and higher efficiency compared to halogen
- › Low weight and high corrosion resistance thanks to high-quality materials and coatings

## PRODUCT FEATURES

With the S-series, FORVIA HELLA is launching new LED work lamps from the Module 90 series that offer a high light output with a practical design. The Module 90 S-series from FORVIA HELLA combines innovative LED technology with excellent value for money. Thanks to their compact dimensions, the flush-mounted work lamps can be used universally and existing halogen lamps can be quickly and easily converted to powerful LED technology.

In addition, the Module 90 S-series work lamps impress with 1,850 lumens (variant II) – or as premium LED work lamps with a high light output of 4,000 lumens (variant IV). The excellent lumen/watt performance achieves a high efficiency compared to halogen devices.

The lamps' new, efficient cooling fin design with better heat dissipation ensures a long service life. The particularly effective integrated thermal management protects the lamp with automatic dimming against the threat of overheating between +50 °C and +85 °C.

Weight reduction and high corrosion resistance are ensured in the variant II by the housing and cover lenses made of special plastic. The powerful variant IV is equipped with a high-quality die-cast aluminium housing: corrosion protection is achieved through the surface coatings.

Produced in Austria according to the latest technological standards, the work lamps meet the highest EMC requirements.

# TECHNICAL DETAILS

Technical data		
Variant	II	IV
Operating voltage range	Multi-voltage (9–32 V)	
Rated voltage	12 V and 24 V	
Current consumption	12 V: Ø1.29 A* 24 V: Ø0.61 A**	12 V: Ø2.95 A* 24 V: Ø1.34 A**
Power consumption	12 V: Ø17 W* 24 V: Ø17 W**	12 V: Ø39 W* 24 V: Ø37.5 W**
Light output (warm)	Ø1,850 lm	Ø 4,000 lm
Light source	LED	
Colour temperature	6,500 K***	
Material	Housing: plastic	Housing: die-cast aluminium
	Cover lens: plastic	
Weight	256 g	575 g
Temperature range	-40 °C to +85 °C (overheating protection)	
Protection class	IP 6K7, IP 6K9K	
Approved	ECE-R10	
Compliant	RCM, CISPR 25 Class 5	
Protection	Polarity reversal protection, overvoltage protection	
Mounting	Flush mounting	
Connection	DEUTSCH DT connector, 2-pin	
Manufactured in	Austria	

\* Warm measured at 13.2 V after 30 minutes of operation.

\*\* Warm measured at 28 V after 30 minutes of operation.

\*\*\* 5,000 K variants available on request.

## Dimensional sketch

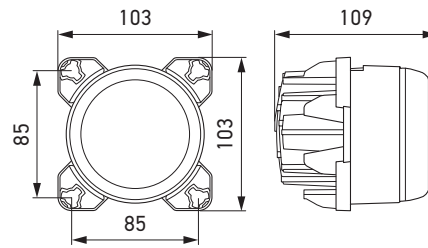
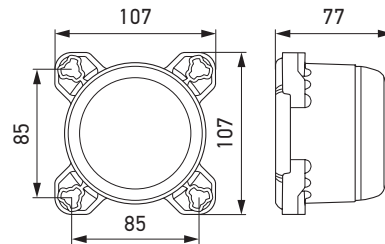



# PROGRAM OVERVIEW

Product picture	Variant	Illumination	Part number	VPE*
	II	Close-range illumination	1G0 996 463-007	40
		Long-range illumination	1G0 996 463-017	40
	IV	Close-range illumination	1G0 996 463-407	40
		Long-range illumination	1G0 996 463-417	40

\* Packaging unit

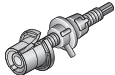
# ACCESSORIES

Product picture	Description	Part number
	Adjusting screw group: 3x ball screw, 3x thread fitting, 3x joint piece	9NS 254 242-091
	2,000 mm cable with DEUTSCH DT connector	8KB 990 299-011

# LIGHT DISTRIBUTION

## Variant II

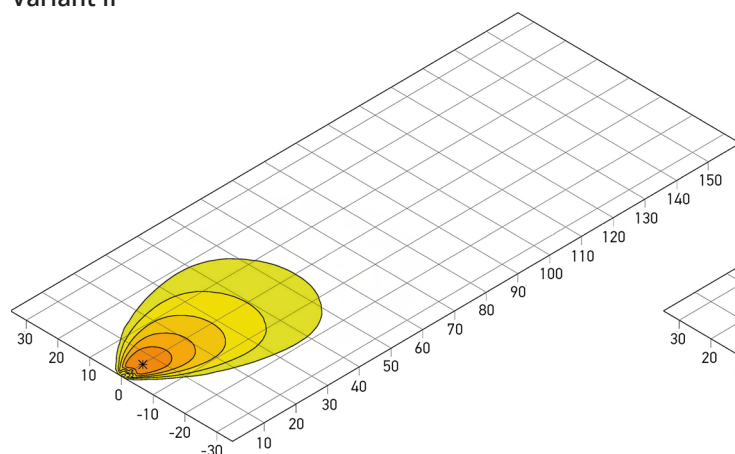

Close-range illumination

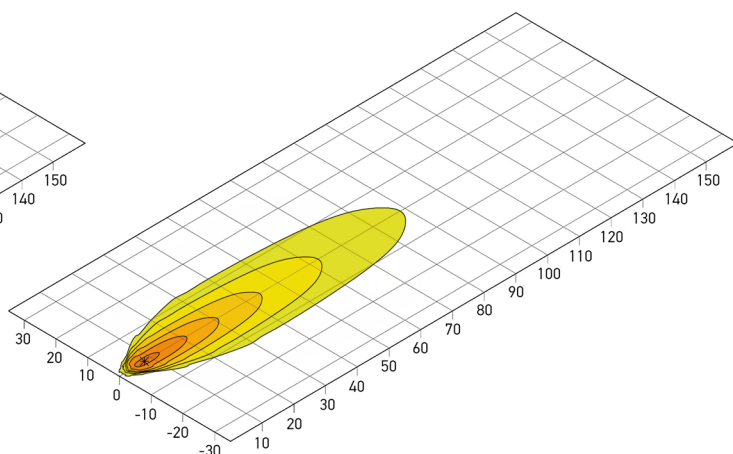

Long-range illumination

## Variant IV

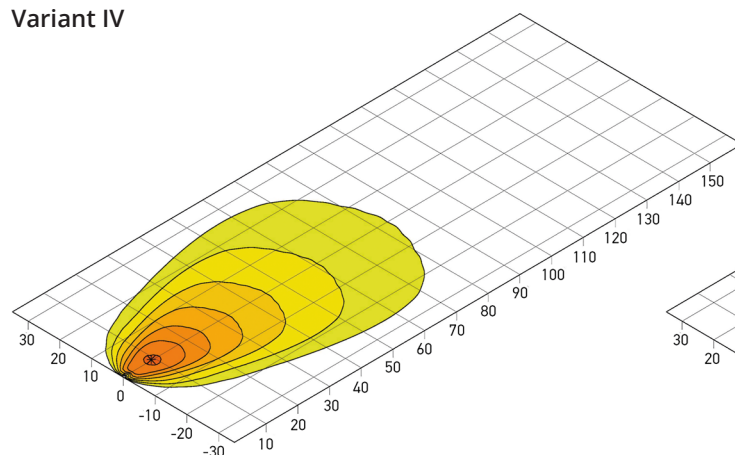

Close-range illumination

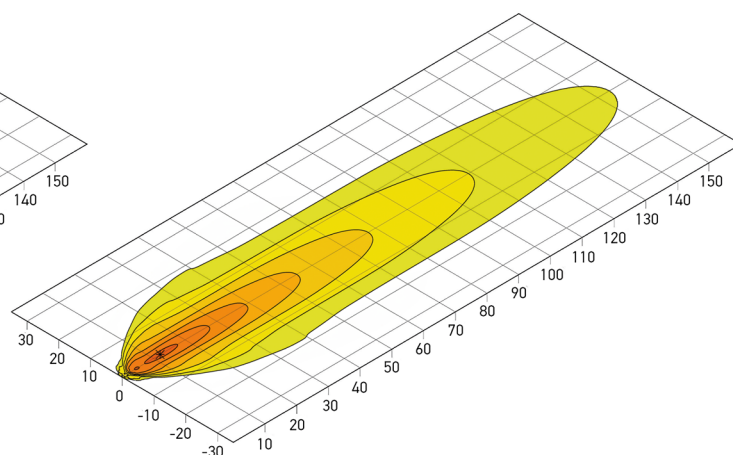

Long-range illumination

lux >= 0  1  2  4  8  16  32  64  128  192  256

Mounting position: 2.5 m high at -8° (close-range illumination) or -3° (long-range illumination)