

7 Pole Metal Socket



Rubber Boot 9GD 735 641-001

4901	8JB 001 941-004 - Metal Housing	
4901BULK	8JB 001 941-005 - Metal Housing	PACK OF 25
Description	Metal housing with securing cap locks plug in position.	
Maximum Load	20A @ 12V (total). 10A @ 24V (total).	
Accessory	9GD 735 641-001 Rubber boot	
Wiring Standards	AS2513, ISO1724 (Light duty)	

7 Pole Plastic Plug



4902	8JA 905 386-001 - Plastic Housing	
Description	Black Plastic Plug with strain relief.	
Maximum Load	20A @ 12V (total). 10A @ 24V (total).	
Wiring Standards	AS2513, ISO1724 (Light duty)	

7 Pole Plastic Plug



4909	8JB 001 939-003 - Plastic Housing	
Description	Simply stores in boot until required. Requires no permanent bumper mounting.	
Maximum Load	20A @ 12V (total). 10A @ 24V (total).	
Wiring Standards	AS2513, ISO1724 (Light duty)	

7 Pole Metal Plug

4911	8JA 001 918-003 - Metal Housing	
4911BULK	8JA 001 918-004 - Metal Housing	PACK OF 25
Description	Metal housing.	
Maximum Load	20A @ 12V (total). 10A @ 24V (total).	
Wiring Standards	AS2513, ISO1724 (Light duty)	



7 Pole Plastic Socket

4912	8JB 001 943-091 - Plastic Housing	
Maximum Load	20A @ 12V (total). 10A @ 24V (total).	
Accessory	9GD 735 641-001	Rubber boot
Wiring Standards	AS2513, ISO1724 (Light duty)	



Rubber Boot 9GD 735 641-001

8JB 910 032-041	
IP Rating	IPX7 and IPX9K
Wire Size	1.0 – 2.5mm ²
Standard	ISO 1724
Wiring Standards	AS2513, ISO1724 (Light duty)

7 Pole Weatherproof Socket

Weatherproof 7 Pole round socket for light duty applications. Fully sealed including at cable entry and socket access door. Crimp style connections require a crimping tool to suit "VKS-Plus" style terminals.



7 Pole Flat Socket



4920	8JB 910 032-011	
Maximum Load	20A @ 12V (total) 10A @ 24V (total)	
Wiring Standards	AS2513 Flat (Light duty)	

7 Pole Flat Weatherproof Socket

Weatherproof 7 Pole Flat socket for light duty applications. Fully sealed including at cable entry and socket access door. Crimp style connections require a crimping tool to suit "MCP 2.8" style terminals.



8JB 910 032-021		
IP Rating	IPX7 and IPX9K	
Wire Size	1.5 - 2.5mm ²	
Wiring Standards	AS2513 Flat (Light duty)	

7 Pole Flat Plug

Mates with all standard 7 and 12 pole connectors.



4921	8JA 910 032-001	
4921-BULK	8JA 910 032-002	PACK OF 50
Maximum Load	20A @ 12V (total) 10A @ 24V (total)	
Wiring Standards	AS2513 Flat (Light duty)	

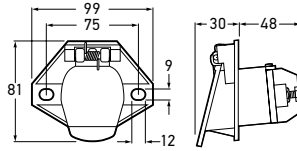

2 Pole Socket - 200A

2 Pole Socket designed for applications with high current draw requirements. Easy to install and operates interdependently of lighting circuit.



4941	8JB 905 394-011	SOCKET
Maximum Load	200A @ 12V	

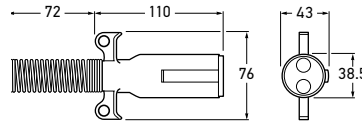

2 Pole Plug - 200A

2 Pole Socket designed for applications with high current draw requirements. Easy to install and operates independently of lighting circuit.



4940	8JA 905 394-001	PLUG
Maximum Load	200A @ 12V	

4907	8JB 003 833-002	SOCKET
4908	8JA 003 831-002	PLUG
Maximum Load	15A @ 24V with 1.5mm ² cable (total) 20A @ 24V with 2.5mm ² cable (total)	7 x 40A @ +12V 7 x 20A @ +24V
Suitability	4907 suits 4908, 4934 & 4934NY 4908 suits 4907, 4935 & 4935NY	
Wiring Standards	ISO 1185, SAE J560, AS4735	

7 Pole Heavy Duty Plug and Socket

Plug and Socket made from metal, with screw terminals (ISO 1185).



7 Pole Heavy Duty SAE Plug - Metal

Heavy-duty 7 Pole Metal Plug manufactured in accordance with AS 4735-2003 (ISO1185 & SAE J560B) standards. Features die-cast zinc housing, high-conductivity 100 percent brass floating pins held between sonic-welded inserts and spring cable guard for additional support and protection. Larger finger grips set back from the latched socket lid allow for safe and trouble-free disconnection.

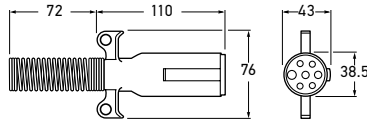

4934	8JA 905 392-001	PLUG
Maximum Load	70A @ 12V	
Suits	Part No. 4907, 4935 and 4935NY	
Wiring Standards	ISO 1185, SAE J560, AS4735	

7 Pole SAE Socket - Metal

Heavy-duty 7 Pole Metal Socket die-cast in robust zinc and manufactured in accordance with AS 4375-2003 (ISO1185 & SAE J560B) standards. Features include full opening lid for ease of plug insertion and extended front barrel housing for added plug support. Raised internal ribs allow for drainage of moisture to prevent corrosion and short circuits. Includes protective rubber boot, Part No. 4936.

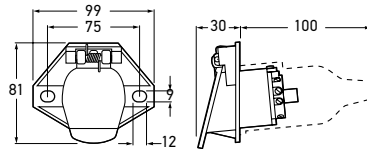

4935	8JB 905 392-021	SOCKET
Mounting	58.9mm diameter opening	
Maximum Load	70A @ 12V	
Suits	Part No. 4934 and 4934NY	
Spare part	4936 Protective Rubber Boot ^①	
Wiring Standards	ISO 1185, SAE J560, AS4735	

7 Pole SAE Socket - Weatherproof

Weatherproof 7 Pole socket for heavy vehicle applications. Also suitable where a water-resistant socket is required (some hazardous goods applications). Fully sealed including at cable entry and socket access door. Crimp style connections require a crimping tool to suit "Double B-Crimp with seal" style terminals.

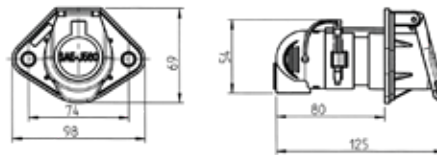

8JB 905 392-051	
IP Rating	IPX7 and IPX9K
Cable Size	AWG 10-12 (4.0-6.0 mm ²) for all cables except earth, AWG 8 (10.0 mm ²)
Wiring Standards	ISO 1185, SAE J560, AS4735



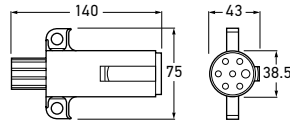

4934NY	8JA 905 392-011	PLUG
Maximum Load	70A @ 12V	
Suits	Part No. 4907, 4935 and 4935NY	
Wiring Standards	ISO 1185, SAE J560, AS4735	

7 Pole SAE Plug - Nylon

Heavy-duty 7 Pole Plug manufactured in accordance with AS 4735-2003 (ISO1185 and SAE J560B) standards. The ultra-durable nylon housing is of lightweight and resistant to degreasers, solvents and contact cleaners. Other features include high-conductivity 100 percent brass pins, exclusive cable guard and 360 degree compression clamp creating a rear moisture seal, whilst also preventing accidental cable pull out.

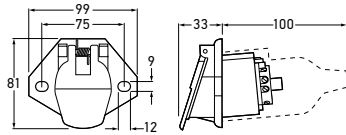

4935NY	8JB 905 392-031	SOCKET
Mounting	58.9mm diameter opening	
Maximum Load	70A @ 12V	
Suits	Part No. 4934NY and 4934	
Spare Part	4936 Protective Rubber Boot ①	
Wiring Standards	ISO 1185, SAE J560, AS4735	

7 Pole SAE Socket - Nylon

Heavy-duty 7 Pole Socket made from composite glass-filled nylon and manufactured in accordance with AS 4735-2003 (ISO1185 & SAE J560B) standards. The ultra-durable nylon housing is of lightweight and resistant to petrochemicals, solvents and contact cleaners. Raised internal ribs allow for drainage of moisture to prevent corrosion and short circuits. Other features include full opening lid and extended front barrel housing for additional support and protection. Supplied complete with protective rubber boot, Part No. 4936.



ISO1185 / SAE J560 Socket / Lead Tester

Circuit testers make diagnosing wiring and lighting issues on trailers quick and easy in the field. Socket testers check the status of connections on the vehicle while the plug tester can be used at the end of a connection lead attached to the vehicle output socket.

8PD 004 508-011 - 7 Pin ISO1185 / SAE J560 Socket Tester	SOCKET
8PD 004 508-021 - 7 Pin ISO1185 / SAE J560 Plug Tester	PLUG
Wiring Standards	ISO 1185, SAE J560, AS4735



8PD 004 508-011

8PD 004 508-021