



## BRIEF INFORMATION

### Rota LED beacon

- › Rotating LED light function
- › Long lifetime
- › Flat and compact design
- › Low current consumption, high efficiency

## PRODUCT FEATURES

The Rota LED is available with a rotating or flashing light function. No moving parts are required for these functions – so no wear and maximum reliability. Since LEDs are maintenance-free, they do not cause any additional costs for spare parts or maintenance. Downtime is reduced to a minimum. The shock-absorbent rubber base makes it extremely resistant to vibrations and therefore especially suitable for demanding applications.

The shock-resistant dome made of polycarbonate protects against impacts (e.g. from branches). Three different installation options i.a.w. DIN 14620 and SAE ensure a solution for every application: Permanent installation (Ø 130 mm and Ø 150 mm), pipe socket and magnetic attachment.

# TECHNICAL DETAILS

## Technical data

Operating voltage range	Multi-voltage (10 – 30 V)
Rated voltage	12 V and 24 V
Current consumption	Rotating: approx. 0,8 A (12 V), approx. 0,4 A (24 V)
Power consumption	Rotating: approx. 9 W
Light function	Rotating
Material	Dome: polycarbonate
Temperature range	-40°C to +60°C
Protection class	IP 5K4K, IP X9K
Approved	ECE-R10, ECE-R65 TA1 (amber), ECE-R65 TB1 (blue), ECE-R65 TR1 (red), ADR / GGVSEB
Compliant	SAE J845 class 2, CISPR 25 Class 5
Protection	Polarity reversal protection
Mounting	Upright

## Dimensional sketch

### Fixed attachment (F)

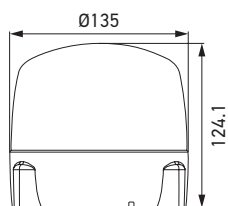

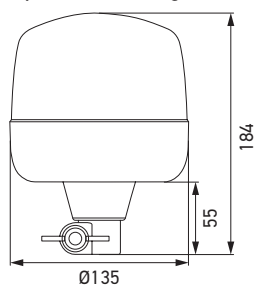

### Pipe socket mounting (P)

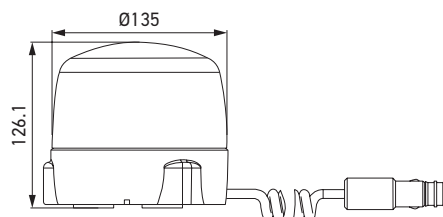

### Magnet mounting (M)



# PROGRAM OVERVIEW

Product Image	Part number, Rotating	Description
	2RL 010 979-001	Rota LED beacon F, amber
	2RL 010 979-011	Rota LED beacon P, amber
	2RL 010 979-021	Rota LED beacon M, amber

## Accessories

9EL 181 506-001	Dome (polycarbonate), amber