



ADR - APPLICATION AND MOUNTING INSTRUCTIONS
ADR 48/00 Licence Plate Lamp

LED NUMBER PLATE LAMP

Multivolt capable 8 - 28 volts

Two Lamps must be mounted as follows

- Lamp mounting surface must be parallel with the number plate surface.
- Lamps must be mounted at each end of the number plate, refer to diagram 1 below.
- Or, lamps must be mounted on top of the number plate, refer to diagram 2 on following page.

Lens Marking and ADR 13/00 Installation Requirements

This Number Plate Lamp, identified by lens marking 9590 and the logo was manufactured to comply with ADR 48/00 Devices for Illumination of Rear Registration Plates:

- A tolerance of +/-3° applies on all mounting details.
- Geometric visibility of registration plate:
 - Vertical: From 5° above to 5° below the horizontal
 - Horizontal: From 30° left to 30° to the right

NB: Two lamps are required for ADR compliance.

Diagram 1

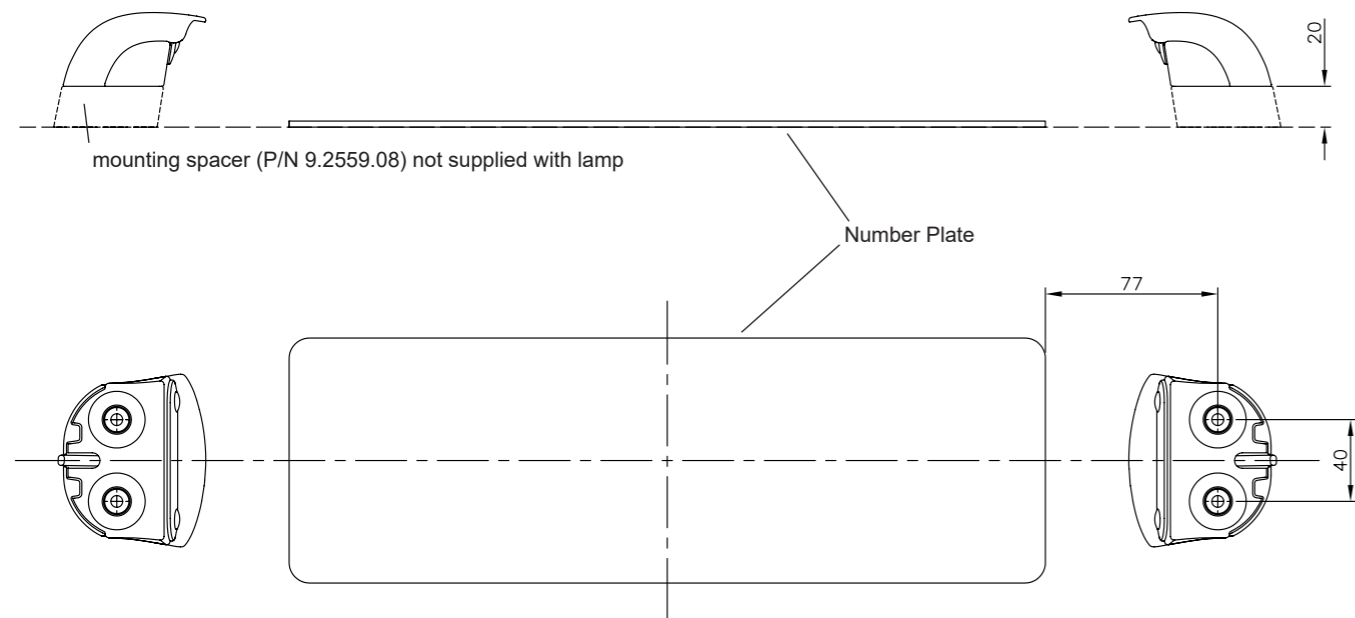

All dimensions in millimetres

PART NUMBER	CTA NUMBER	ADR 51/00 GLOBE	LENS IDENTIFICATION NO.
2559 2KA 959 640-0xx 959.640-0xx	CTA-042545	N/A LED	9590

HELLA-New Zealand Limited, Auckland



ADR - APPLICATION AND MOUNTING INSTRUCTIONS
ADR 48/00 Licence Plate Lamp

LED NUMBER PLATE LAMP

Multivolt capable 8 - 28 volts

Two Lamps must be mounted as follows

- Lamp mounting surface must be parallel with the number plate surface.
- Lamps must be mounted at each end of the number plate, refer to diagram 1 below.
- Or, lamps must be mounted on top of the number plate, refer to diagram 2 on following page.

Lens Marking and ADR 13/00 Installation Requirements

This Number Plate Lamp, identified by lens marking 9590 and the logo was manufactured to comply with ADR 48/00 Devices for Illumination of Rear Registration Plates:

- A tolerance of +/-3° applies on all mounting details.
- Geometric visibility of registration plate:
 - Vertical: From 5° above to 5° below the horizontal
 - Horizontal: From 30° left to 30° to the right

NB: Two lamps are required for ADR compliance.

Diagram 1

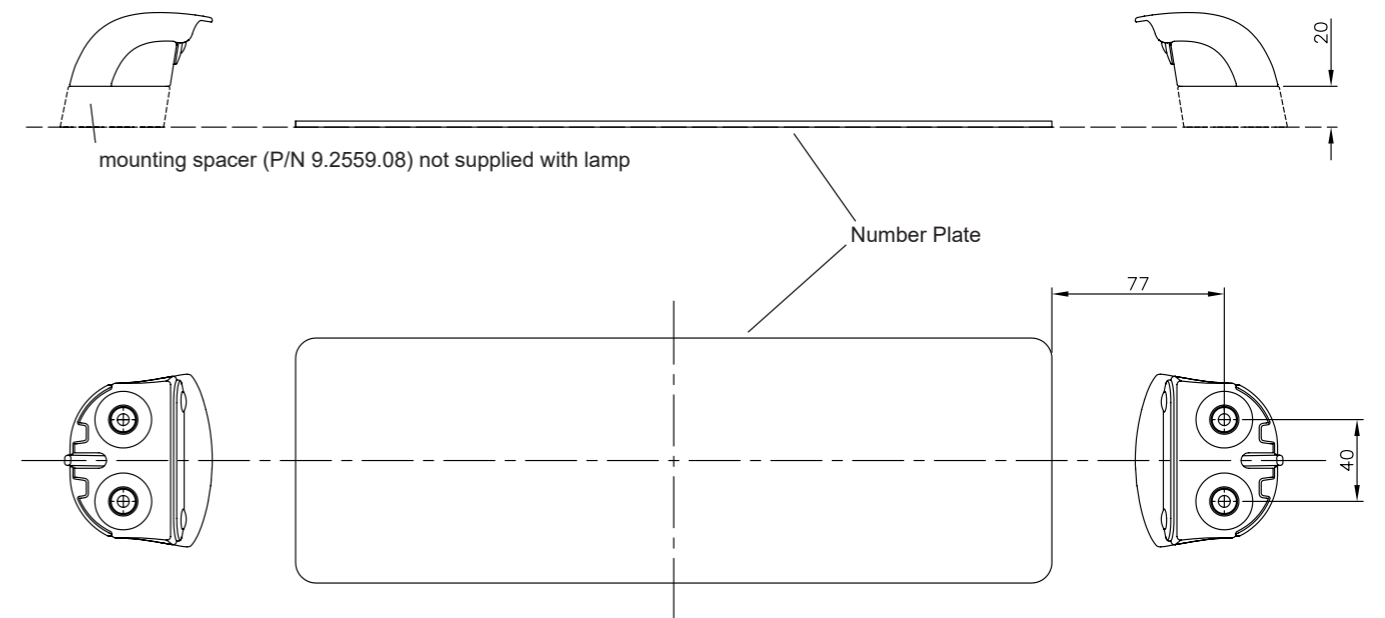

All dimensions in millimetres

PART NUMBER	CTA NUMBER	ADR 51/00 GLOBE	LENS IDENTIFICATION NO.
2559 2KA 959 640-0xx 959.640-0xx	CTA-042545	N/A LED	9590

HELLA-New Zealand Limited, Auckland

INSTRUCTION SHEET
for: **2KA 959 640-0xx / 2559**



Diagram 2 - Alternative mounting

NB: Mounting spacer is not required when the lamp is mounted above the number plate.

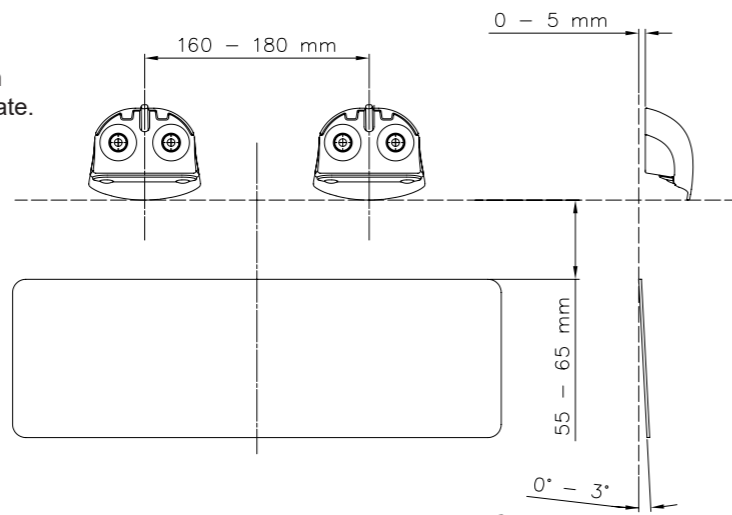

Lamp Base Mounting Instructions

- Mounting holes up to 6.5mm Ø at 40mm centres, for 6 mm bolts, are recommended to mount the base using the supplied mounting bushes (see diagram 3).
- For lamp mounting position see diagram 1 overleaf and diagram 2 above.
- If the lamp cable is to be routed through the mounting surface, ensure the cable hole has no sharp edges to cut or chafe the cable.
- Mounting spacer is available as a spare part (P/N 9.2559.08).

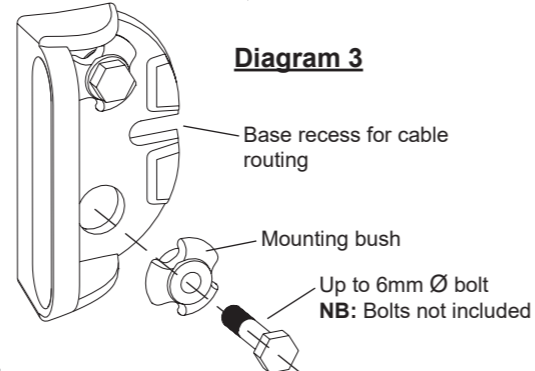

Lamp Module Instructions

- Pass cable through lamp module aperture in base and route through base.
- The cable can also be routed through the lamp cover by removing the material from the recess (see diagram 4).
- Locate the lamp module into the base, and place the locating lugs of the lamp cover into the base recesses.
- Mount the lamp module and cover with the supplied screws, and fit screw caps.

Diagram 4

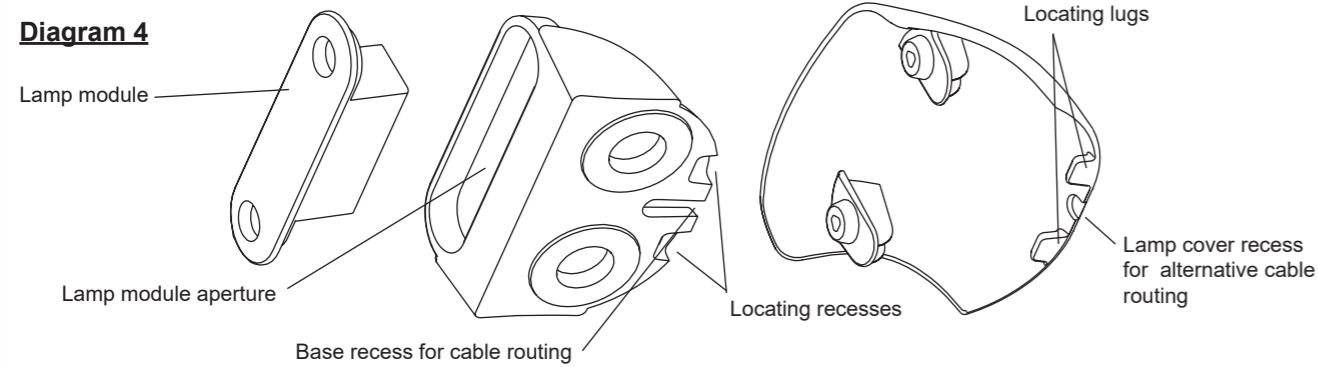

Wiring Colour Coding

The LED Number Plate Lamp is Multivolt capable allowing full light output between 8 and 28 volts. LED lamp modules are polarity conscious. Reverse polarity will not damage this product but will inhibit its function. Hella recommends wire connections be soldered, and heat shrink tubing applied to seal the joint.

Colour	Connect to	Power Consumption
Black	Earth (-)	-
White (Red trace)	Positive (-)	0.4 Watts @ 12 volts 0.8 Watts @ 24 volts

NB: Lamp must be protected by a fuse rated at 2 amperes maximum.

Compatibility to existing electrical systems

It is important for the installer to ascertain the compatibility of the low power consumption LED lamps with the electrical and/or electronic systems of the complete vehicle, including trailers. In most cases the reduced power consumption is beneficial by imposing less demands on the entire electrical system. For certain functions some electrical systems rely on a set power consumption for monitoring whether, for example, a trailer is connected. Operation of this lamp using alternating current or modulated direct voltage will cause premature light failure. HELLA recommends connecting ADR or ECE certified Multivolt LED signal and marker lamps to a continuous (unmodulated) 12V or 24V power supply to ensure safe light operation.

For general comments about Hella's products please contact us on E-mail at techfeedback@hella.co.nz

INSTRUCTION SHEET
for: **2KA 959 640-0xx / 2559**



Diagram 2 - Alternative mounting

NB: Mounting spacer is not required when the lamp is mounted above the number plate.

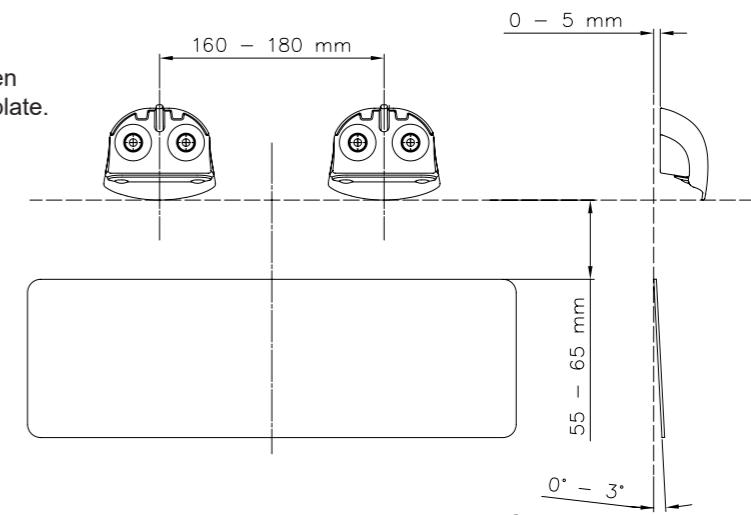

Lamp Base Mounting Instructions

- Mounting holes up to 6.5mm Ø at 40mm centres, for 6 mm bolts, are recommended to mount the base using the supplied mounting bushes (see diagram 3).
- For lamp mounting position see diagram 1 overleaf and diagram 2 above.
- If the lamp cable is to be routed through the mounting surface, ensure the cable hole has no sharp edges to cut or chafe the cable.
- Mounting spacer is available as a spare part (P/N 9.2559.08).

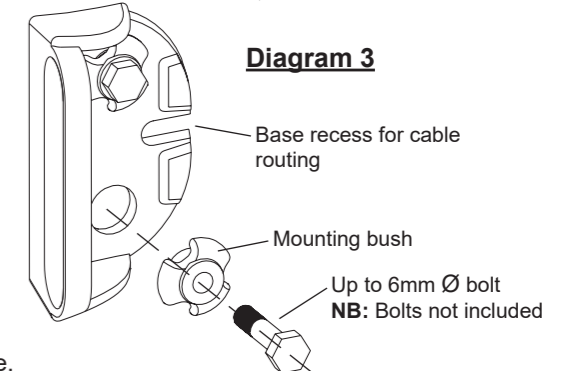

Lamp Module Instructions

- Pass cable through lamp module aperture in base and route through base.
- The cable can also be routed through the lamp cover by removing the material from the recess (see diagram 4).
- Locate the lamp module into the base, and place the locating lugs of the lamp cover into the base recesses.
- Mount the lamp module and cover with the supplied screws, and fit screw caps.

Diagram 4

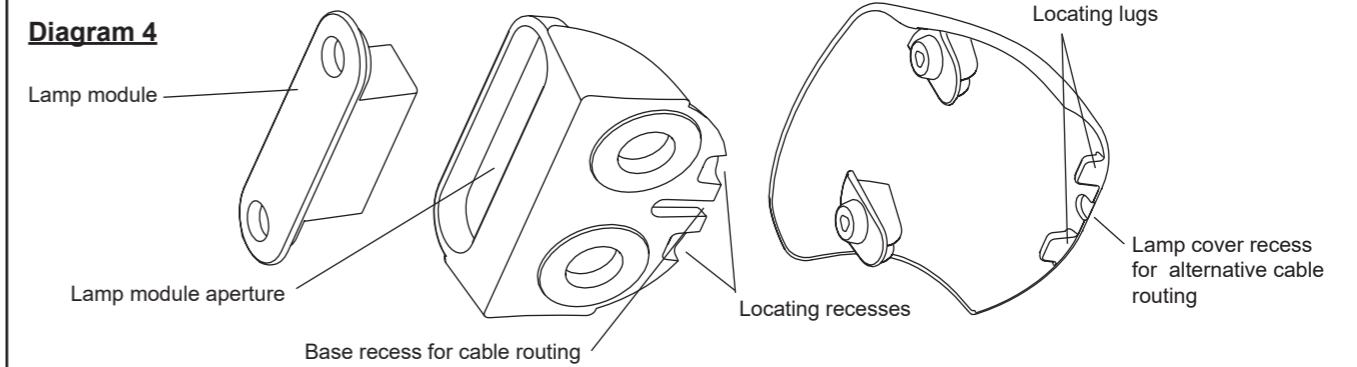

Wiring Colour Coding

The LED Number Plate Lamp is Multivolt capable allowing full light output between 8 and 28 volts. LED lamp modules are polarity conscious. Reverse polarity will not damage this product but will inhibit its function. Hella recommends wire connections be soldered, and heat shrink tubing applied to seal the joint.

Colour	Connect to	Power Consumption
Black	Earth (-)	-
White (Red trace)	Positive (-)	0.4 Watts @ 12 volts 0.8 Watts @ 24 volts

NB: Lamp must be protected by a fuse rated at 2 amperes maximum.

Compatibility to existing electrical systems

It is important for the installer to ascertain the compatibility of the low power consumption LED lamps with the electrical and/or electronic systems of the complete vehicle, including trailers. In most cases the reduced power consumption is beneficial by imposing less demands on the entire electrical system. For certain functions some electrical systems rely on a set power consumption for monitoring whether, for example, a trailer is connected. Operation of this lamp using alternating current or modulated direct voltage will cause premature light failure. HELLA recommends connecting ADR or ECE certified Multivolt LED signal and marker lamps to a continuous (unmodulated) 12V or 24V power supply to ensure safe light operation.

For general comments about Hella's products please contact us on E-mail at techfeedback@hella.co.nz